



## QUICK-STEP® Installation Kit

LAMINATE *Parquet* LIVYN



### Product description

The Quick-Step® Installation kit is a complete kit for laying your floor professionally and quickly. Code: QSTOOLA

### Content:

- 25 spacers
- Tapping block
- Crowbar

### Applications

The installation kit enables you to lay your floor correctly with the Uniclic system, without risk of damaging it.

### Characteristics

- √ A complete set  
You can find everything you need to lay your Quick-Step® floor professionally in this single set.
- √ Provides a constant and sufficiently wide expansion joint  
Wood is the main component of this floor. Room humidity can vary from season to season, so it is vital that the floor is able to expand and contract. The floor has to be able to expand or contract in all directions. This is why an expansion joint of at least 8 to 10 mm/0.32 to 0.39in. is provided around the floor.  
The spacers provided with the set are placed between the planks and the wall to obtain the required expansion joint.
- √ Rigid Vinyl is a thermoplast and expands and shrinks with temperature changes; therefore this also needs expansion gaps

✓ Specially developed for the Uniclic system

Use the Uniclic tapping block to tap the planks into position with a hammer, without damaging the tongue. The tapping block actually has a groove that fits perfectly over the tongue.



✓ Handy for use in tight spots

The Quick-Step® crowbar facilitates the installation of the floor in places which are difficult to reach (e.g. against the wall or under a radiator).

The shape and length guarantee a professional installation.

✓ Reusable

The Quick-Step® installation kit consists of high-grade tools which can be used many times.



*The use of accessories other than the Quick-Step® solutions might cause damage to the Quick-Step® floor. In such case the guarantee provided by Quick-Step® will be void. We therefore advise to use only Quick-Step® solutions as these have been especially designed and tested for the use with Quick-Step® floor panels.*

## Instructions

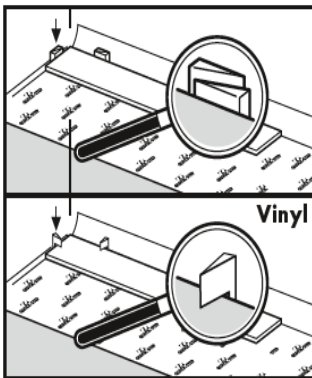

✓ Put spacers between the planks and the wall when installing your floor. They provide a uniform and sufficient expansion joint of 8 to 10 mm/0.32 to 0.39in.. Place the spacers about every 30 cm/ 1 ft.

Tip: use 2 spacers (for laminate & wood): the narrow side of one spacer against the thick side of another. With this "double spacer" you can easily compensate for most unevenness in the wall.

✓ Use the special lip in the spacers to click them onto the thinner rigid vinyl. This way your spacers won't fall over and you can keep a consistent expansion gap.

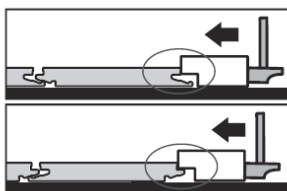

✓ Place the Uniclic tapping block with the groove on top of the plank tongue and tap the planks into the correct position with a hammer.

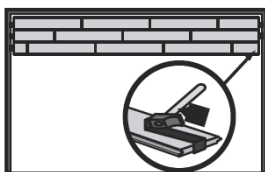

✓ Sometimes the tapping block cannot be used if there is not enough space (e.g. against the wall or under a radiator). The Quick-Step® crowbar is ideal for these situations. To place the plank correctly, put the Quick-Step® crowbar over the edge of the plank and tap the plank into the correct position with a hammer.